

**IMPORTANT! PLEASE, READ CAREFULLY THESE INSTRUCTIONS
AND KEEP THEM IN A SAFE PLACE FOR FUTURE REFERENCE!**

**INSTRUCTION MANUAL FOR
USE OF BABY CARRIER
„HIP STAR”**

HIP STAR
babycarrier



The product **chipolino** is produced in compliance with Product Safety Directive 2001/95/EC of the European Parliament and the council and European Standard EN 13209-2:2015 “Child use and care articles - Baby carriers - Safety requirements and test methods - Part 2: Soft carrier”, as well as the Consumers Protection Law of the national legislation.

TO ENSURE THE SAFETY OF YOUR CHILD DURING USE OF THIS PRODUCT, FOLLOW THE INSTRUCTIONS, WARNINGS AND GUIDELINES FOR USE GIVEN IN THIS MANUAL:

WARNING! DO NOT LEAVE CHILD UNATTENDED WHILE IN THE CARRIER!

WARNING! THIS PRODUCT IS INTENDED FOR CARRYING BABIES AND VERY LITTLE CHILDREN FROM 4 MONTHS UP WHO CAN SIT AND WEIGHING UP TO 15KG.

WARNING! FOR NEWBORN BABIES WHO ARE UNDERWEIGHT AND BABIES WITH HEALTH ISSUES IT IS RECCOMENDED THAT YOU FIRST CONSULT YOUR DOCTOR BEFORE USING THIS PRODUCT!

WARNING! YOUR BALANCE MAY BE IMPAIRED BY BOTH YOUR AND YOUR BABY'S ACTIONS!

WARNING! BE CAREFUL WHEN YOU BEND OVER OR LEAN TO THE SIDE!

WARNING! THIS CARRIER IS NOT SUITABLE FOR USE DURING SPORTS ACTIVITIES!

WARNING! KEEP AWAY FROM FIRE!

- ❖ This product is intended only for one child!
- ❖ The length of the belts must be adjusted according to the child's and adult's sizes in a way that will not hinder their movements.
- ❖ Before each use you must make sure that the buckles and fixing mechanisms are intact and safe, there are no damaged harnesses, torn seams or fabric!
- ❖ If you discover damages, you must cease usage of the product until they are repaired!
- ❖ If you need to bend forward, we recommend first to bend your knees in order to prevent the baby from falling!
- ❖ Use the product only for its purpose!
- ❖ DO NOT use the product while in lying position!
- ❖ When using the carrier in your home, be aware of the danger of different heat sources and spill of hot liquids while carrying the child!
- ❖ Do not make changes or modifications on the product! Contact the authorized service or the trader where you purchased the product for advice and repair.
- ❖ Do not use spare parts or other components, which have not been supplied by the manufacturer! Chipolino is not responsible in case that spare parts which are not supplied or approved by manufacturer were used.
- ❖ Keep away the plastic packaging in order to avoid risk of suffocation!

MAIN FEATURES

- ❖ Suitable for children older than 4 months, with weight 3.5 up to 15 kg;
- ❖ Baby positions in hip seat mode:



Lying

Suitable from
4 up to 36 months



Facing out

Suitable from
6 up to 36 months



Facing in

Suitable from
6 up to 36 months

WARNING! ALWAYS SUPPORT THE BABY WITH YOUR ARMS WHEN BABY IS IN LYING POSITION!

- ❖ Baby positions in carrier mode:



Facing out

Suitable from
4 up to 36 months



Facing in

Suitable from
4 up to 36 months



Back carrying

Suitable from
6 up to 36 months

MAIN PARTS OF THE BABY CARRIER

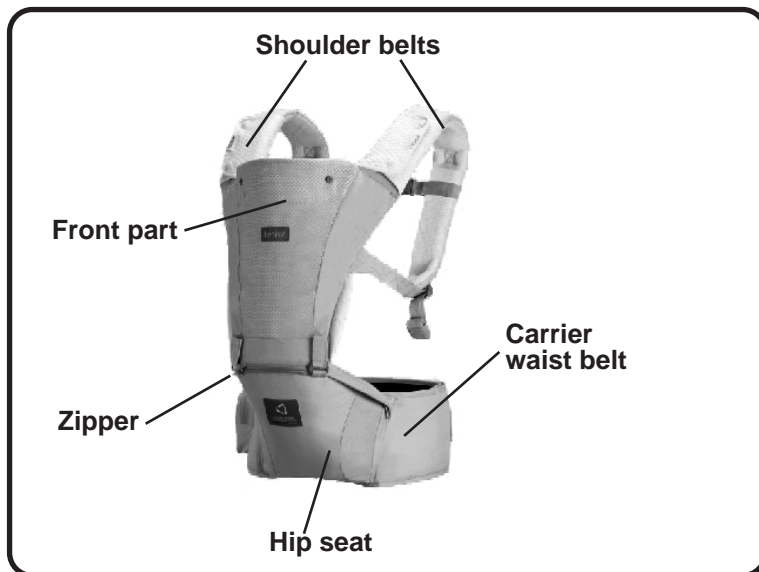

FUNCTIONS

IMPORTANT! THE BABY'S POSITION ACCORDING TO ADULT'S BODY MAY BE ACHIEVED BY ADJUSTING BELTS' LENGTH.

RECCOMENDATION: Before using the baby carrier, we recommend you to try a few times to put the baby in it and to adjust the belts.

1. PLACING THE CHILD IN THE CARRIER IN FACING IN MODE

WARNING! BEFORE USE MAKE SURE THAT THE ZIPPER AND STRAPS ARE CLOSED AND THE BABY'S LEGS ARE PALCED ON BOTH SIDES OF THE HIP SEAT!



1-1 – Fasten the buckle. Pull the waist belt so you can tighten it.

1-2 – Move the hip seat to the front of your body.

1-3 – **WARNING!** Make sure that the waist belt is well fixed and tight and place the baby on the seat facing your body.

1-4 – Put the shoulder belts on your shoulders and adjust the child position to be in the middle of the seat. Fasten the belts buckle.

1-5 and 1-6 – Tighten the shoulder belts.

2. PLACING THE CHILD IN THE CARRIER IN BACK CARRYING MODE MODE

WARNING! BEFORE USE MAKE SURE THAT THE ZIPPER AND STRAPS ARE CLOSED AND THE BABY'S LEGS ARE PALCED ON BOTH SIDES OF THE HIP SEAT!

WARNING! WHEN PUTTING THE CHILD IN THE CARRIER IN A BACK CARRYING MODE, YOU NEED AN ASSISTANT TO HELP YOU!

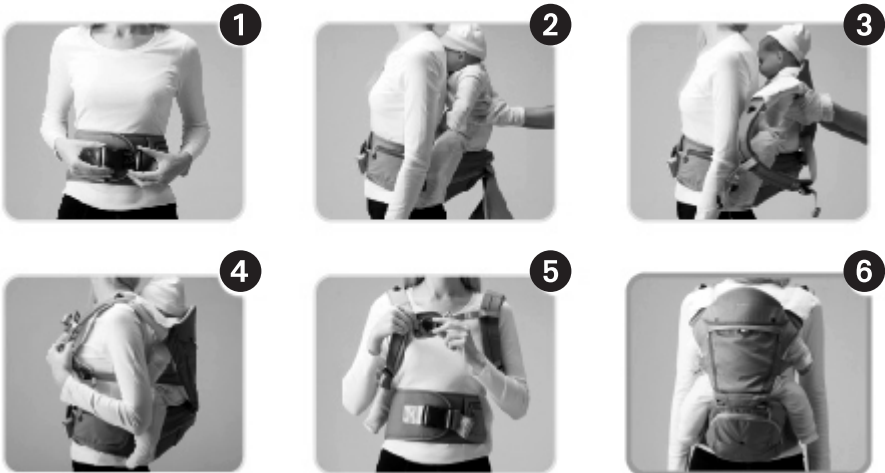

2-1 – Fasten the buckle. Pull the belt in order to tighten it. The seat is at the back.

2-2 and 2-3 – Your assistant must position the child in the middle of the seat facing adult's back, as shown in the picture.

2-4 and 2-5 – Put the shoulder belts on your shoulders and fasten the buckle. Tighten the belts.

2-6 – Child is in the carrier in back carrying mode.

3. PLACING THE CHILD IN THE CARRIER IN FACING OUT MODE

(the child is at carrier's chest and looking forward)

WARNING! BEFORE USE MAKE SURE THAT THE ZIPPER AND STRAPS ARE CLOSED AND THE BABY'S LEGS ARE PALCED ON BOTH SIDES OF THE HIP SEAT!



3-1 – Fasten the buckle. Pull the waist belt, in order to tighten it.

3-2 – Position the hip seat at the front of your body.

3-3 – **WARNING!** Make sure that the waist belt is well fixed and tight and place the baby on the seat facing forward – his back at your chest.

3-4 – Put the shoulder belts on your shoulders and adjust the child position to be in the middle of the seat.

3-5 – Fasten the belts buckle.

3-6 – Tighten the shoulder belts.

WARNING! BEFORE USE MAKE SURE THAT THE ZIPPER AND STRAPS ARE CLOSED AND THE BABY'S LEGS ARE PALCED ON BOTH SIDES OF THE HIP SEAT!

4. PLACING THE CHILD IN THE CARRIER IN HIP SEAT MODE.

WARNING! ALWAYS SUPPORT THE BABY WITH YOUR ARMS WHEN BABY IS IN LYING POSITION!



Unzip the front part of the carrier and detach it in order to use only the hip seat.

CARE AND MAINTENANCE GUIDELINES:

- ❖ The seat and plastic parts must be cleaned with soft detergent and damp cloth.
- ❖ Do not clean with aggressive detergents, containing abrasive parts, ammonia, bleach or spirit.
- ❖ You can hand or machine wash the belts at temperature up to 30°C. Follow the washing label on the product.
- ❖ Do not tumble dry! Do not iron!
- ❖ Always let the product dry fully before storing or using it. If the product is stored wet, this can cause mold.
- ❖ Store the product in a clean and dry place. Do not expose directly to environment factors - sunlight, rain, moisture or harsh temperature amplitudes!

Used materials: textile and plastic



KENHS022xxx/ C26



CHIPOLINO LTD., 1 Goliamokonarsko Shosse Str, Plovdiv, BULGARIA;

www.chipolino.com