

**IMPORTANT! READ CAREFULLY THIS INSTRUCTION MANUAL AND KEEP IT FOR FUTURE REFERENCE IN A SAFE PLACE, BECAUSE IT CONTAINS IMPORTANT INFORMATION FOR THIS PRODUCT AND ITS SAFE USAGE!**

## **ИНСТРУКЦИЯ ЗА ПОЛЗВАНЕ НА ПОСТЕЛКА ЗА БЕБЕШКА ГИМНАСТИКА**

# **BABY PLAY MAT**

**This play mat with its toys is suitable for newborn babies and babies aged up to 5 months. It stimulates baby's senses and it has entertaining functions only. Balls that go with the play mat are suitable for children aged 1 year and up.**

**This product is produced in conformity with the Toy safety directive of European Parliament and the Council 2009/48/EO. It is made of high quality and safe materials.**

**ATTENTION!** FOLLOW THE GUIDELINES AND RECOMMENDATIONS IN THESE INSTRUCTIONS! PAY SPECIAL ATTENTION TO THE WARNINGS IN ORDER TO PREVENT RISK FROM INJURY OR IMPAIRMENT OF THE CHILD AND TO SECURE ITS SAFETY!

## INSTRUCTIONS AND WARNINGS FOR SAFE USAGE OF THE PRODUCT

### IMPORTANT! MAIN WARNINGS!

1. TO BE USED ONLY UNDER DIRECT ADULT SUPERVISION! Constant presence, control and supervision by adult is required!
2. TO AVOID RISK FROM ENTANGLEMENT, REMOVE THE TOYS WHEN THE CHILD STARTS TRYING TO RISE OR PUSH ITSELF UP ON HANDS AND KNEES! Such abilities children have when they are around 5 months and up!
3. USE ONLY AT HOME.
4. DO NOT PLACE THE PLAY MAT ON EVEN SURFACES OR SURFACES WITH SLOPE, WHEN THERE IS A BABY ON IT. PLACE THE PLAY MAT ONLY ON EVEN SURFACES AND AT A SAFE DISTANCE FROM STAIRS, SOURCES OF HEAT, WATER POOLS OR OTHER DANGEROUS PLACES WHILE THERE IS A CHILD ON IT!
5. KEEP AWAY FROM FIRE. Pay attention to risk of injuries caused by open fire and other strong sources of heat, located at the level of play mat!
6. Unpacking and assembly must be done only by an adult!
7. Do not hang on the arches any additional toys, objects or other items, strings and cords, because this can make the construction unstable and to avoid risk from entanglement, suffocation or their falling over the child.
8. Regularly check the condition of all parts, the seams of the play mat, the plush toys as well as the stability of the toy bar and toys to avoid injuries of the baby. Baby must not have any access to small parts from the filling in case there are torn stitches of the play mat or its toys. If you find any damages, stop the usage of the product until the damage is repaired.
9. Do not make repairs or other adjustments on the toys and toy bar while there is a child on the play mat!
10. The safety of this product and the materials used is confirmed by tests. Safety is guaranteed by the producer in the shape in which the product is produced and released to the market. Any modification carries serious risk of injury of the child.
11. Use the nylon package of the play mat only for its purpose – to store or transport of the play mat. It can be dangerous for children. Keep it away from children in order to avoid the risk of suffocation!

## IMPORTANT! WARNINGS AND GUIDELINES FOR BATTERY USE

- ❖ After installation of batteries, always secure the battery compartment with the cover.
- ❖ Do not allow children to access or play with the batteries!
- ❖ Use only batteries of the designated type and power.
- ❖ Do not use batteries of different types.
- ❖ Do not short circuit the contact surfaces!
- ❖ Follow the designated polarity in the battery compartment.
- ❖ Remove damaged or worn out batteries.
- ❖ Remove the batteries when the product will not be used for long time.
- ❖ Do not throw the batteries in open fire. Do not take the batteries to pieces.

**CAUTION!** Waste from depleted or unusable batteries must be disposed of separately. It is forbidden to throw them out in containers for household waste. Dispose of the batteries only at the specified places.



## ATTACHING THE TOY BAR AND TOYS

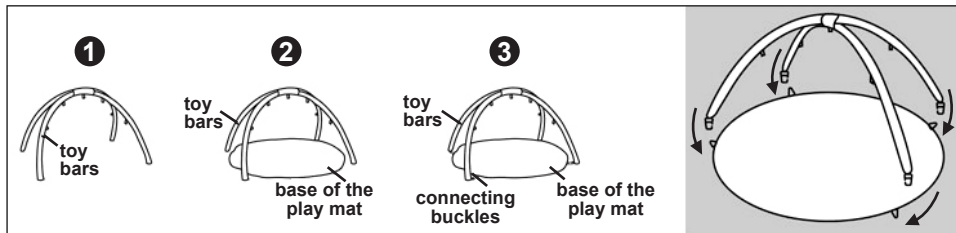

1. Place both arches in textile tube.
2. Place the play mat base onto the even surface. Thread the bars into the openings on the base.
3. Fix the toy bars to the base using the buckles.

Plastic toys holders can be open for easy cleaning. When you attach back the toys, make sure the holders are securely locked.

— 1.5V “AA” +

**Batteries: 2 pcs size AA/1.5V  
(not included)**

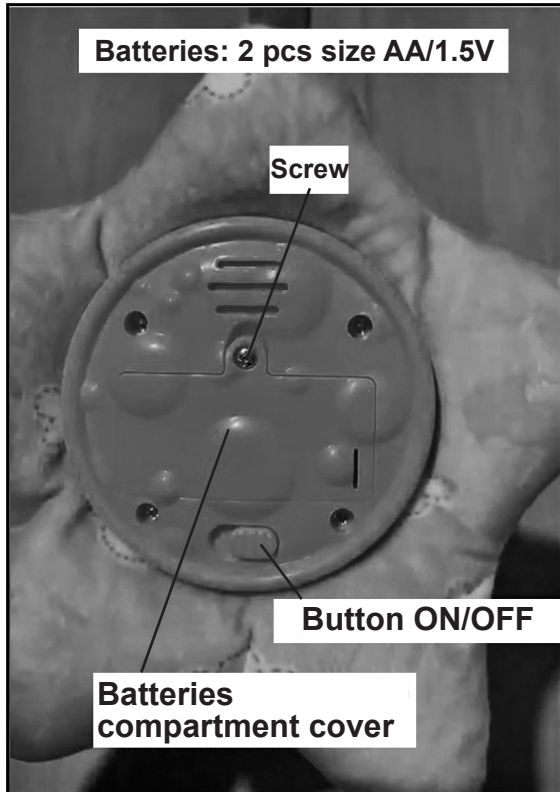

Untighten the screw on the batteries compartment cover (at the back of the star toy) with a screwdriver and remove the cover.

Insert 2 pcs batteries size AA/1,5V, obeying the given polarity. Place back the cover and tighten the screw to secure the batteries compartment.

To active the functions (melodies), slide ON/OFF button.

## CARE AND MAINTENANCE

If you find any broken or damaged parts of the toys and/or play mat, stop using it until it is repaired.

Do not store the product in a damp environment for a long time, close to heat sources and under the influence of direct sunlight.

Play mat and toys (without musical box) are hand washable in water at 30°C and detergent suitable for baby clothes.

Make sure you rinse well the detergent before you leave them dry!

Do not machine wash or tumble dry.

Toy bars and musical toy can be wiped with soft cloth damped with water and mild soap.

Do not clean with aggressive detergents containing ammonia, bleach or spirit.

After cleaning and washing all parts of the product must be completely dry before using or storing.

**Materials used:** plastic, textile – 100% polyester.

PGR02304AFR / CC8726  
PGR02303BAL / CC8727  
PGR02301LIO / CC8728  
PGR02302FOR / CC8729  
PGR02305JUR / CC8731

**Producer:** Made in China for "CHIPOLINO" EOOD  
**Importer:** CHIPOLINO EOOD  
1 Goliakonarsko Shosse Str, Plovdiv, BULGARIA  
tel.: +359 32 600 889,

[www.chipolino.com](http://www.chipolino.com)